



- NOTES
1. ALL WORKS TO BE IN ACCORDANCE WITH AUCKLAND COUNCIL STANDARDS.
 2. COORDINATES IN TERMS OF NZ GEODETIC DATUM MT EDEN 2000. LEVELS IN TERMS OF THE AUCKLAND VERTICAL DATUM 1946.
 3. IT IS THE CONTRACTORS RESPONSIBILITY TO LOCATE ALL SERVICES THAT MAY BE AFFECTED BY HIS OPERATIONS.
 4. PIPE BEDDING: 0 - 10% GRANULAR BEDDING, 10 - 20% WEAK CONCRETE BEDDING GREATER THAN 20% WEAK CONCRETE BEDDING (7MPA PLUS ANTI SCOUR BLOCKS AT 6M CRS).
 5. EACH CONNECTION SHALL BE MARKED BY A 50MMx50MM TREATED PINE STAKE EXTENDING 600MM ABOVE GROUND LEVEL WITH THE TOP PAINTED. THIS MARKER POST SHALL BE PLACED ALONGSIDE A TIMBER MARKER INSTALLED AT THE TIME OF PIPELAYING AND EXTENDING FROM THE CONNECTION TO 150MM BELOW FINISHED GROUND LEVEL. CONNECTIONS SHALL BE ACCURATELY INDICATED ON "AS BUILT" PLANS.
 6. APPROVED HARDFILL IS TO BE USED IN BACKFILLING OF ALL ROAD CROSSINGS AND VEHICLE CROSSINGS TO COUNCIL STANDARDS.
 7. HEAVY DUTY MANHOLE LIDS AND FRAMES TO BE USED IN TRAFFICED AREAS.
 8. ALL MANHOLES ARE TO BE 1050MMØ PRECAST CONCRETE UNLESS SHOWN OTHERWISE.
 9. ALL CATCHPIT LEADS SHALL HAVE MIN COVER 1.0M.
 10. ALL LINES TO BE ABANDONED SHALL BE SEALED AT EACH END. TIMING OF ALL SEALING TO BE COORDINATED WITH COUNCIL STAFF.
 11. ALL LOT CONNECTION TO BE MIN 100mm uPVC SN16 UNLESS SHOWN OTHERWISE.

Legend

	EX BDY
	PROP BDY
	EX STORMWATER
	PR STORMWATER
	EX/PROP SWMH
	PROP SWCP SINGLE
	PROP SWCP DOUBLE

B	RC S92	AS	03/2024
A	RC	YG	08/2023
Rev	Description	By	Date
Survey	Easdale Surveyors LTD	05/2020	
Design	APS	07/2023	
Drawn	EZ	07/2023	
Checked	AC	07/2023	

M **Maven Associates**
 09 571 0050
 info@maven.co.nz
 www.maven.co.nz
 5 Owens Road, Epsom
 Auckland 1023

Project
538 KARANGAHAPE ROAD, NEWTON 1010. AUCKLAND FOR JAMES KIRKPATRICK GROUP LTD.

Title
PROPOSED STORMWATER DRAINAGE PLAN

Project no.	274001
Scale	1:250 @ A3
Cad file	C400.DWG
Drawing no.	C400
Rev	B

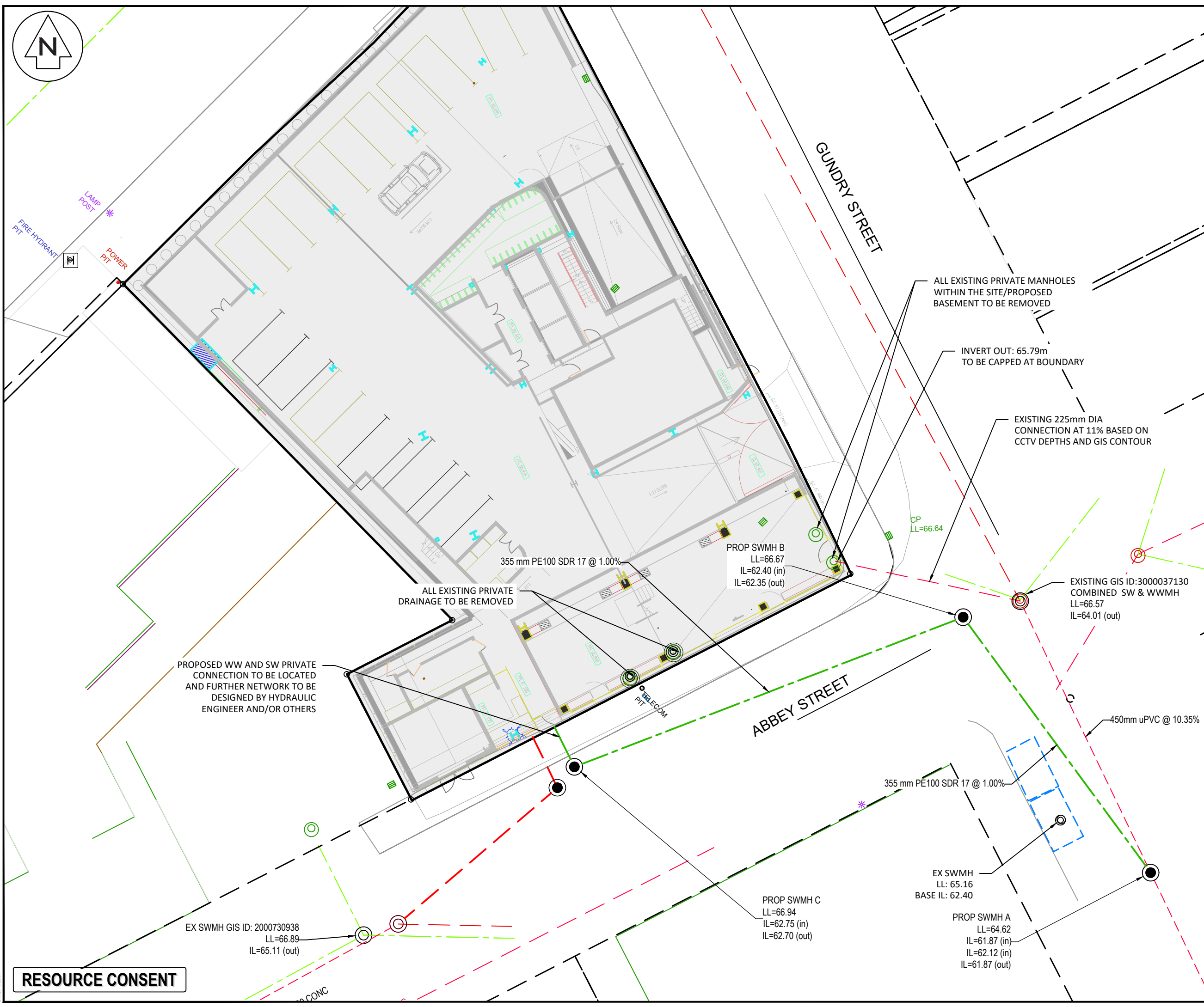

RESOURCE CONSENT

DATE: 3/20/24



- NOTES
1. ALL WORKS TO BE IN ACCORDANCE WITH AUCKLAND COUNCIL STANDARDS.
 2. COORDINATES IN TERMS OF NZ GEODETIC DATUM MT EDEN 2000. LEVELS IN TERMS OF THE AUCKLAND VERTICAL DATUM 1946.
 3. IT IS THE CONTRACTORS RESPONSIBILITY TO LOCATE ALL SERVICES THAT MAY BE AFFECTED BY HIS OPERATIONS.
 4. PIPE BEDDING: 0 - 10% GRANULAR BEDDING, 10 - 20% WEAK CONCRETE BEDDING GREATER THAN 20% WEAK CONCRETE BEDDING (7MPA PLUS ANTI SCOUR BLOCKS AT 6M CRS).
 5. EACH CONNECTION SHALL BE MARKED BY A 50MMX50MM TREATED PINE STAKE EXTENDING 600MM ABOVE GROUND LEVEL WITH THE TOP PAINTED. THIS MARKER POST SHALL BE PLACED ALONGSIDE A TIMBER MARKER INSTALLED AT THE TIME OF PIPELAYING AND EXTENDING FROM THE CONNECTION TO 150MM BELOW FINISHED GROUND LEVEL. CONNECTIONS SHALL BE ACCURATELY INDICATED ON "AS BUILT" PLANS.
 6. APPROVED HARDFILL IS TO BE USED IN BACKFILLING OF ALL ROAD CROSSINGS AND VEHICLE CROSSINGS TO COUNCIL STANDARDS.
 7. HEAVY DUTY MANHOLE LIDS AND FRAMES TO BE USED IN TRAFFICED AREAS.
 8. ALL MANHOLES ARE TO BE 1050MMØ PRECAST CONCRETE UNLESS SHOWN OTHERWISE.
 9. ALL CATCHPIT LEADS SHALL HAVE MIN COVER 1.0M.
 10. ALL LINES TO BE ABANDONED SHALL BE SEALED AT EACH END. TIMING OF ALL SEALING TO BE COORDINATED WITH COUNCIL STAFF.
 11. ALL LOT CONNECTION TO BE MIN 100mm uPVC SN16 UNLESS SHOWN OTHERWISE.

Legend

	EX BDY
	PROP BDY
	EX STORMWATER
	PR STORMWATER
	EX/PROP SWMH
	PROP SWCP SINGLE
	PROP SWCP DOUBLE

Rev	Description	By	Date
B	RC S92	AS	03/2024
A	RC	YG	08/2023

Project
538 KARANGAHAPE ROAD, NEWTON 1010. AUCKLAND FOR JAMES KIRKPATRICK GROUP LTD.

Title
PROPOSED WASTEWATER DRAINAGE PLAN

Project no.	274001
Scale	1:250 @ A3
Cad file	C500.DWG
Drawing no.	C500
Rev	B

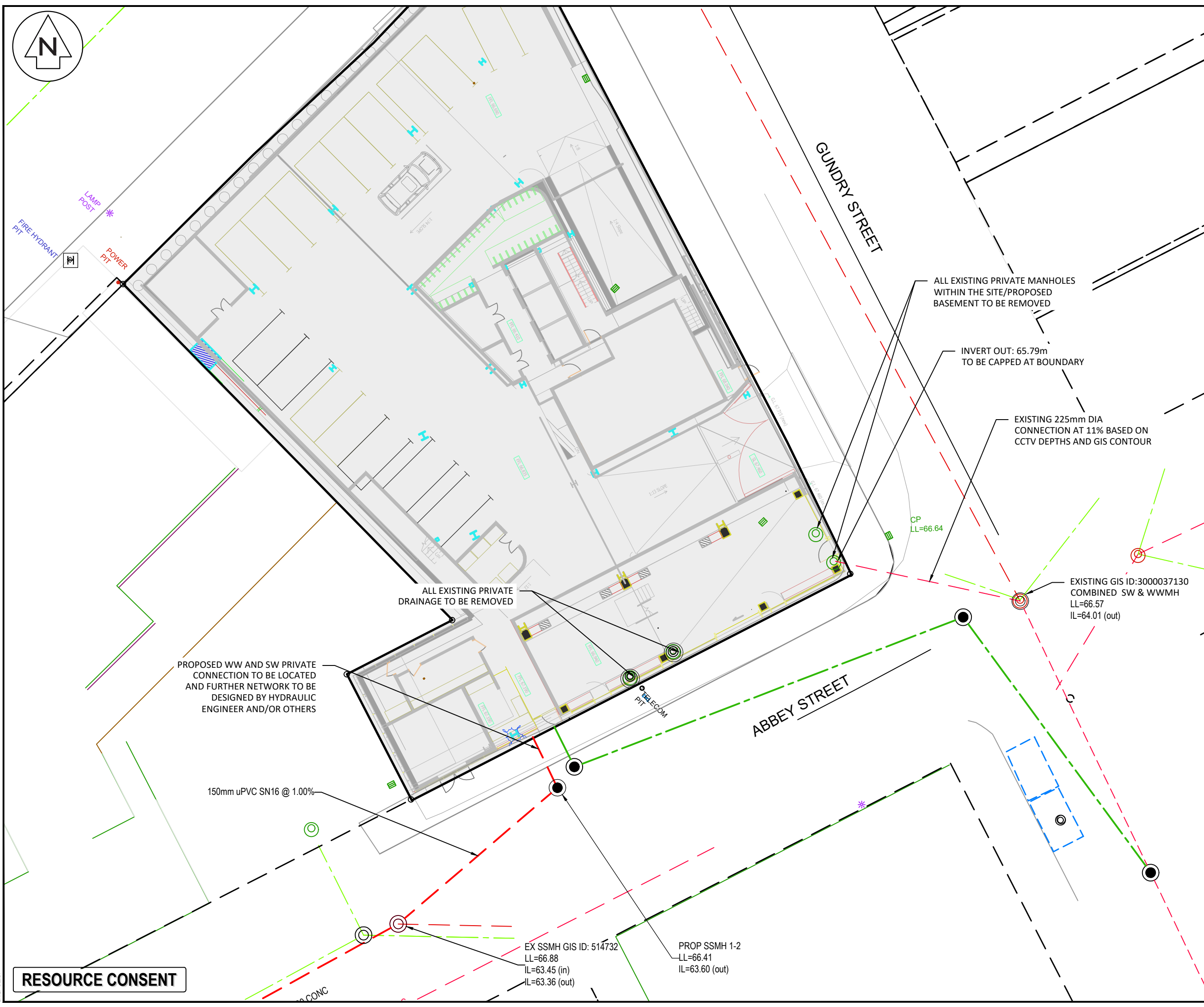

RESOURCE CONSENT

DATE: 30/04